

reer

Instruction manual

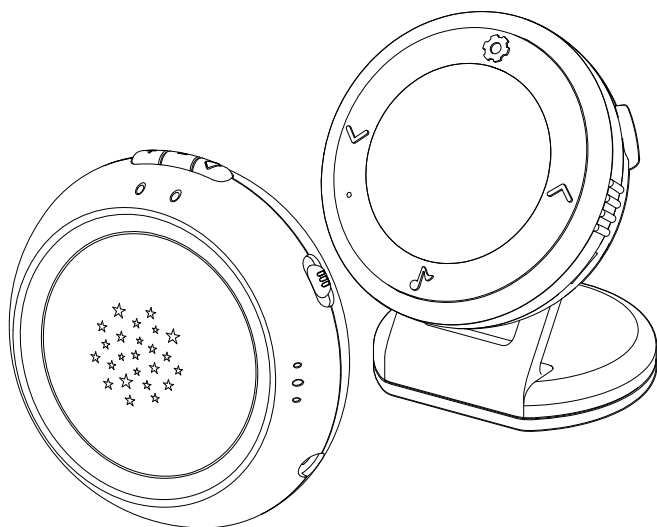

Projector baby monitor

Item no: 50080

Table of Contents

Scope of delivery 1

General information 2

Technical data and functions 2

General safety instructions 3

Safety instructions regarding installation 4

Description of babyphone 5

- Description of babyphone
- Baby unit/transmitter
- Menu and Symbols

Putting into operation 6

Functional options 7

- Baby unit
- Coupling
- Parent unit

Troubleshooting 11

Warranty 12

Notes on environmental protection 13

Scope of delivery

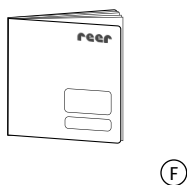
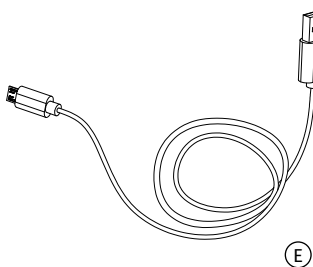
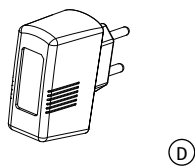
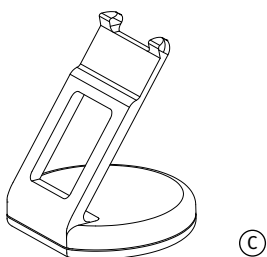
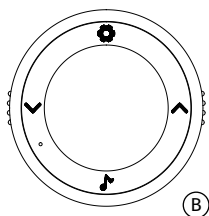
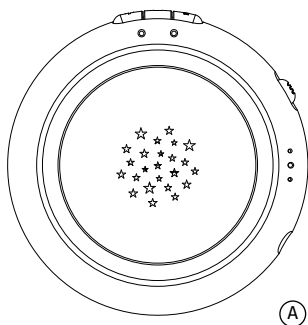

A: Baby unit/transmitter
B: Parent unit/receiver
C: Stand for parent unit

D: USB power supply
E: 2x USB cable
F: Instruction manual

Projector baby monitor

Congratulations on your decision to purchase a new reer projector baby monitor. The projector baby monitor consists of a parent unit with intercom function and a baby unit with integrated star projector and lullaby feature. Your new projector baby monitor uses a highly sensitive microphone to provide you with clear and reliable feed of any sounds your baby makes. It uses modern FHSS technology to ensure interference-free transmission and guarantee a secure and private connection.

Suitable for both stationary and mobile use thanks to optional battery operation. We're confident you'll enjoy the quality of our product for many years to come. Please take a few minutes to carefully read through the safety instructions. Safe operation of the reer projector baby monitor can only be guaranteed if all guidelines listed here are followed. Please keep the instruction manual in a safe place for future reference.

Technical data and functions

Technology	Digital, FHSS, 865 MHz
Frequency	865 MHz
Transmitter baby unit	Power supply with mains adapter DC 5V 600mA or optional 3x 1.5V AAA batteries (not included)
Receiver parent unit	Power supply with mains adapter DC 5V 600mA or optional built-in 3.7V 750mAh Li-ion battery/rechar- geable (built into device)
Range	Up to 650 m
Maximum battery life (in stand- by mode)	Baby unit: Up to 22 hours Parent unit: Up to 57 hours
Working temperature	-10°C to +50°C

General safety instructions

- ! Check the unit for visible damage before each use. If you detect any damage, do not use the unit.
- ! Only use the supplied chargers and mains adapters.
- ! Make sure that the operating voltage of the power outlet matches that of the mains adapter.
- ! Check - especially when travelling abroad - that the local mains voltage matches the voltage specified on the units and/or mains adapters.
- ! Except for the battery compartment cover, never open the units or mains adapters, as there is a risk of electric shock.
- ! If a unit does not work correctly, please do NOT try to fix the problem yourself. Please contact your dealer with any problems.
- ! Avoid bringing the battery and/or electrical connection contacts on the units into contact with metal objects.
- ! This product is not a toy! Do not allow children to play with the unit.
- ! This baby monitor was designed exclusively for monitoring your baby.
- ! It may neither be regarded as a substitute for parental supervision nor as a medical device.

Safety instructions regarding installation

- Always place the baby unit out of your child's reach (minimum distance: 1 meter).
- Never place the baby monitor inside the crib, cot or playpen.
- The power lead must be secured out of the reach of children to avoid any risk of strangulation. Do not use extension cables.
- To ensure optimal transmission, the units must be kept upright at all times and placed in an elevated position.
- DO NOT place the receiver in the vicinity of radio transceivers or microwaves. Radiant emissions from these devices can significantly affect radio reception.
- Do not use the units near water or in humid places. Do not submerge the units in water. Do not rinse the units under running water.
- Do not cover the baby monitor with towels, clothes or blankets.
- Avoid extreme heat and direct sunlight

Device description

Parent unit / receiver

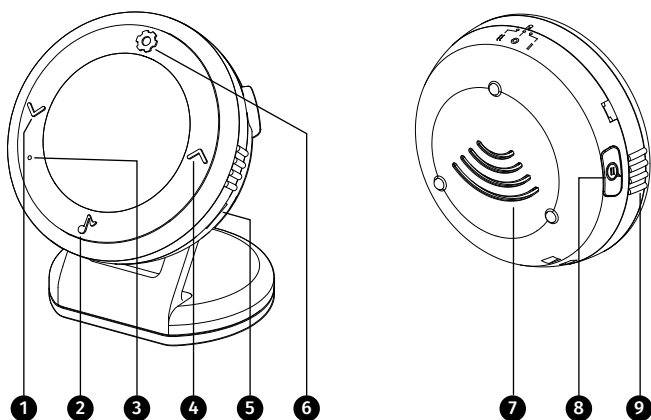

1. Down navigation key
2. Lullaby playback button
3. Microphone
4. Up navigation key
5. Micro USB charging connector
6. Settings button
7. Speaker
8. Intercom button
9. On/off/vibrate rotary switch

Baby unit/transmitter

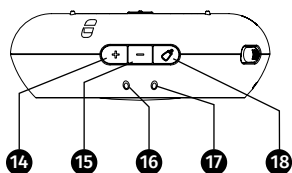
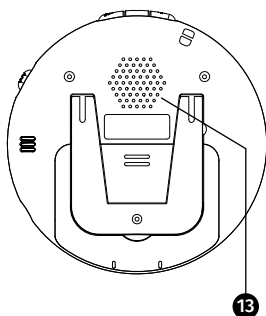
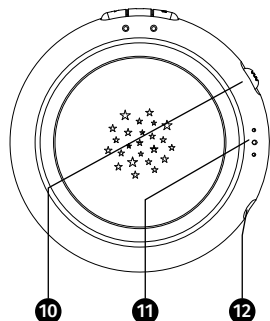

- 10. On/off switch
- 11. Microphone
- 12. Micro USB input for power supply unit
- 13. Speaker
- 14. "+" key louder
- 15. "-" key quieter
- 16. Indicator light/low battery indicator
- 17. Transmission indicator
- 18. Feed alarm button

Menu and symbols

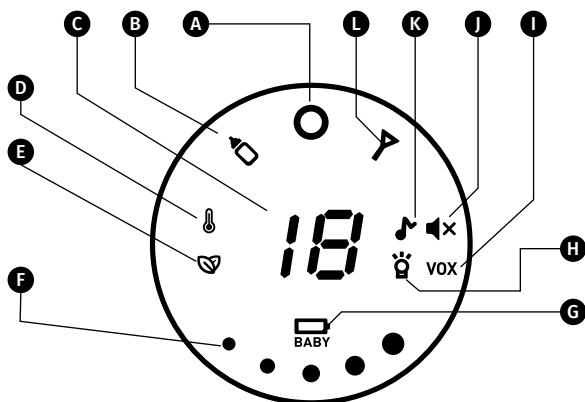

- A: Power indicator:** green light – on
 blinking green light – battery low
 red – battery is charging

- B:** Feed alarm active
- C:** Room temperature at location of baby unit
- D:** Temperature alarm activated
- E:** Eco mode
- F:** Sound level indicator
- G:** Weak battery in baby unit
- H:** Projection light on
- I:** VOX projection light
- J:** Loudspeaker muted
- K:** Lullaby playing
- L:** Baby unit out of range

Start-up

1. Fully charge the parent unit battery.

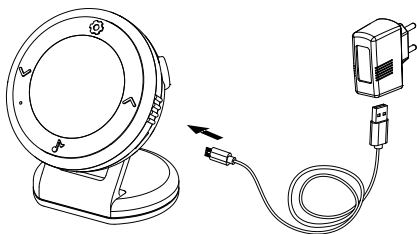

Power indicator lights up red while battery is charging and **CH** appears briefly on display.

Once the battery is fully charged, after approx. 4 hours, the power indicator goes out or lights up green when the device is switched on. After recharging, you can leave the AC adapter connected without risk of damaging the built-in battery.

2. Powering the baby unit

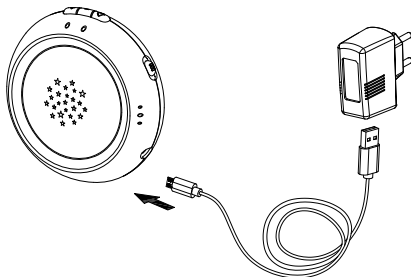

a) Battery operation::

Open the battery compartment after removing the locking screw.
Insert 3 AAA batteries, making sure the polarity is correct.

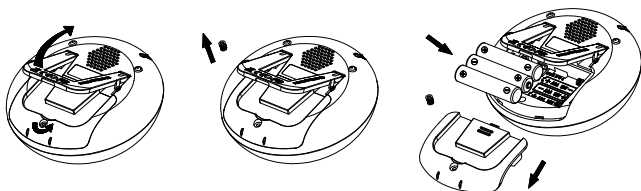

b) Mains operation:

You can operate the baby unit via the mains adapter while batteries are inserted. To do so, connect the baby unit to the power socket using the power adapter provided.

3. Place the baby unit on a stable table.
4. Switch it on by activating the power switch.
5. Switch the parent unit on by turning the rotary switch [9] to "I" or II. The power indicator [A] is now constantly lit in green. In II - mode you are alerted with a vibration as soon as the device records any noise, while in "I" mode there is no vibration.
6. The devices are coupled in the factory to ensure they are ready for immediate use, so you can monitor the baby unit from the loudspeaker right away. Should this not be the case, please proceed with the steps outlined below under Coupling.

Functional options:

Baby unit

1. When switched on, the operating indicator (16) is constantly lit in green. When the battery charge is low, the indicator light starts flashing and the  symbol lights up on the screen of the parent unit.
2. The transmission indicator (17) lights up red whenever the baby unit is transmitting. The unit goes into standby mode a few seconds after it stops registering any sound, and the indicator light stops glowing.
3. Microphone sensitivity can be adjusted to 5 levels using the up and down keys (14+15). The transmission indicator flashes between 1 and 5 times, indicating the selected level.

4. You can also adjust the volume of the music or intercom function using the up and down keys (14+15). To do so, activate the corresponding function before setting the desired volume. As long as playback/intercom is/are deactivated, the two navigation buttons adjust microphone sensitivity only.
5. The projector can be controlled from the parent unit. You can choose between continuous operation, power off or operation in VOX mode. In VOX mode, the projection starts when the microphone registers any sound and automatically shuts off a few seconds after no more sound is detected. You can use either a ceiling or wall for projection. To ensure stability when projecting onto a wall, fold out the stand of the baby unit. The best projection quality is obtained at a distance of approx. 1 meter from the projection surface.
6. To start the feed alarm countdown, press button (18). The corresponding icon will then flash on the parent unit's screen. Once the set time has elapsed, an alarm sounds and a timer message appears on the screen. Please note that a change in the alarm time is not automatically accepted by pressing the button on the baby unit. To accept the change, press the button on the baby unit again.
7. The baby unit's inbuilt temperature sensor measures the ambient temperature, which is then shown on the parent unit's display. The sensor works error-free in the range between -19°C and +50°C. In the case of a rapid change of temperature, it may take a few minutes for the sensor to adapt and display the correct temperature. If the local temperature is out of this range or the baby unit is out of service, - - is displayed on the screen.

Coupling

1. Press and hold the settings button (6) on the parent unit.
2. Now turn the rotary switch [9] to switch on the unit. Release the settings button (6) after you hear a beep. The screen now shows the flashing symbols "p" and "1".
3. Switch the baby unit on by moving the power switch while holding down the "+" button (14). Release the "+" button once the transmission indicator is lit up. The transmission indicator will then flash.

4. Now press the feed alarm button (18). The baby unit's transmission indicator is now constantly lit – the "p" symbol on the parental unit's display will no longer flash if the pairing is successful.
5. Switch off both units.
6. Now switch the two units back on – and the baby monitor is ready for use.
7. If there is still no connection, repeat steps 1-6.

Parent unit

1. If the parent unit does not receive any signal from the baby unit while switched on, its screen switches off automatically after 20 seconds to save energy, with the exception of the power indicator.
2. The power indicator lights up green during operation, flashes green when weak and lights up red during charging.
3. To enter the settings mode, press and hold the settings button (6) for about 2 seconds. To save your entry and move to the next menu item in the sequence, press the settings button again.

a) Projector

Use the arrow buttons to select whether to switch the projection on, off or to VOX mode. In VOX mode, projection only takes place when the baby unit registers sound.

b) Eco mode

Select using the arrow keys

ON: The baby unit does not emit any signal while in standby mode.
(**Caution:** The out of range alarm is deactivated in this mode.)

OFF: If the parent unit is no longer receiving any signal from the baby unit, an alarm sounds and the  icon appears on the screen

c) Upper temperature limit

Using the arrow keys, you can set the upper temperature limit between +10°C and +50°C. If the temperature rises above this, an alarm sounds.

d.) Lower temperature limit

Using the arrow keys, you can set the lower limit between -9°C and +20°C. If the temperature falls below this, an alarm sounds.

e.) 🍼 Feed alarm

Under this menu item, you can set a timer alarm to remind you to e.g. regularly feed your child. You can choose an interval of between 1 and 8 hours at half-hourly increments. When a set alarm is triggered, an alarm sounds and 00 flashes on the display.

4. In order to prevent any unpleasant noises (feedback) from being emitted by the loudspeaker, ensure there is sufficient distance between the parent unit and baby unit.
5. To change the volume, press one of the arrow keys. The temperature display will then briefly fade, and the display will show the volume level instead, from 0 (mute) to 5 (loud).
6. In vibration mode, the parent unit vibrates when receiving sound from the baby unit. This function is useful if parents are in a noisy environment or do not want to disturb their environment with an acoustic alarm. Using vibration mode can significantly shorten battery life.
7. If the parent unit is unable to connect to the baby unit for more than 30 seconds, an acoustic alarm sounds, the 📶 symbol flashes on the screen and the temperature display shows - -. This alarm is not triggered if the low-emission mode (ECO) is activated, or if the baby unit is switched off or disconnected from the power supply (e.g. batteries empty, no mains adapter connected).
8. If the ambient temperature of the baby unit falls outside the set range, an alarm sounds, the 🌡️ symbol lights red (exceeded) or white (below) and the temperature indicator starts flashing.
9. The playback of 6 different lullabies can be controlled via the parent unit. Press the 🎵 key briefly and use the arrow keys to select the desired song. To stop playback, press the 🎵 button again. Once playback has started, the music plays for 20 minutes before switching off automatically so as not to disturb your baby. If your child begins to cry, after 15 seconds the music will turn on again and play for 20 minutes. The intercom function can still be used during playback. It is possible that your child's crying will not be picked up by the microphone during music playback. We therefore strongly recommend you interrupt playback regularly in order to check on your child's activity.

10. You can also use the intercom function to speak to your child and calm them down. Press and hold the intercom button (8) and speak into the microphone (3). To end the intercom, simply release the key (8) again. It is also possible to use the intercom function while the baby unit is transmitting. To check your child's activity, briefly press the intercom button (8). The baby unit will then transmit for a period of 10 seconds even if your child is not active.
11. The confirmation key emits a beeping sound each time any of the 13-16 keys are pressed.
12. To mute the alarm, briefly press buttons 8, 6, 4 or 1. The alarm icon will continue to be displayed until the alarm has ended.

Troubleshooting:

Problem	Possible cause	Action
No transmission from baby unit	<ul style="list-style-type: none"> • Microphone sensitivity is too low • No power supply to baby unit 	<ul style="list-style-type: none"> • Adjust sensitivity in menu • Check power supply, replace batteries if necessary
Permanent transmission	<ul style="list-style-type: none"> • Microphone sensitivity is too high 	<ul style="list-style-type: none"> • Adjust sensitivity in menu
Constant range alarm	<ul style="list-style-type: none"> • Baby unit is switched off or no power supply available • Distance between units is too great • Coupling is faulty or no longer available 	<ul style="list-style-type: none"> • Switch on baby unit or test power supply • Reduce distance between units • Recouple the devices
Constant temperature alarm	<ul style="list-style-type: none"> • The minimum & maximum temperature limit values are too close to the current recorded temperature 	<ul style="list-style-type: none"> • Set limit values to within approx. 5° of the current measured temperature

Problem	Possible cause	Action
Constant low battery indicator	<ul style="list-style-type: none"> Parent unit's batteries/rechargeable battery are empty 	<ul style="list-style-type: none"> Charge the parent unit using the charging cable supplied Replace the batteries in the baby unit or connect the mains adapter
Battery/rechargeable battery runs out too quickly	<ul style="list-style-type: none"> Projection and music playback are constantly activated Vibration mode is activated 	<ul style="list-style-type: none"> Switch off projection and music playback or switch to VOX Switch off vibration mode
Range too small	<ul style="list-style-type: none"> Too much signal interference between units Baby unit battery empty 	<ul style="list-style-type: none"> Reposition baby and parent units Change battery in baby unit
No connection between the units	<ul style="list-style-type: none"> Coupling error 	<ul style="list-style-type: none"> Recouple the devices

Warranty

Please retain your receipt, the user manual and item number. Warranty claims or claims from promises of guarantee must be processed by the dealer. The technical specification, information and characteristics of the product described herein have been compiled to the best of our knowledge and belief and are correct at the time of printing. Any information provided by reer should be correct and authoritative. Nevertheless, reer does not accept liability for potential errors in this document and reserves the right to make changes to the product design and/or specifications without prior notice. Reproduction and disclosure of information contained in this copyrightprotected document, in any form or by any means - graphical, electronic or mechanical by photocopying, recording on tape or storage in a data retrieval system (even in part), require prior written consent from reer.

Note on environmental protection



At the end of its life, this product must not be disposed of as normal domestic waste, but should be recycled at a collection point for electrical appliances. Please see the relevant symbol on the product, in the user manual and packaging. Materials can be recycled as specified. Do not put used batteries into household waste. Instead they should be disposed of as hazardous waste or with a battery collection station provided by the dealer. An important contribution to the protection of the environment can be made by reusing the unit, recycling its components or otherwise reusing old appliances. Please contact your local council to find out more about an appropriate disposal centre.

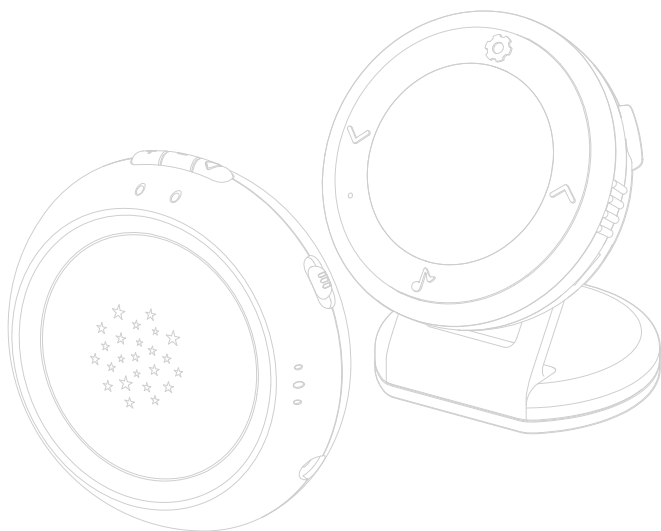

reer GmbH
Muehlstr. 41 • 71229 Leonberg • Germany
www.reer.de

Operation permitted in the following countries:

DE, CH, AT, IT, FR, BE, NL, ES, LU, GR, HU, CZ, SI, PL, CY, DK, FI, IS, LI, LT, NO,
RO, SE, SK, TR

reer GmbH hereby declares that the projector baby monitor radio system
(item no.: 50080) complies with Directive 2014/53/EU. The full text of the EU
Declaration of Conformity can be found at the following website:

<http://www.reer.de>